



输出功率: 约2.0~30.0W

直流无刷电机

典型应用: 医疗器械
精密仪器
家用电器
商业设备

OUTPUT: APPROX 2.0~30.0W

Brushless DC Motor

Typical Applications: Medical Instruments
Precision Instrument
Household Appliances
Business Equipment

1. OUTLINE DRAWING:

UNIT:MM

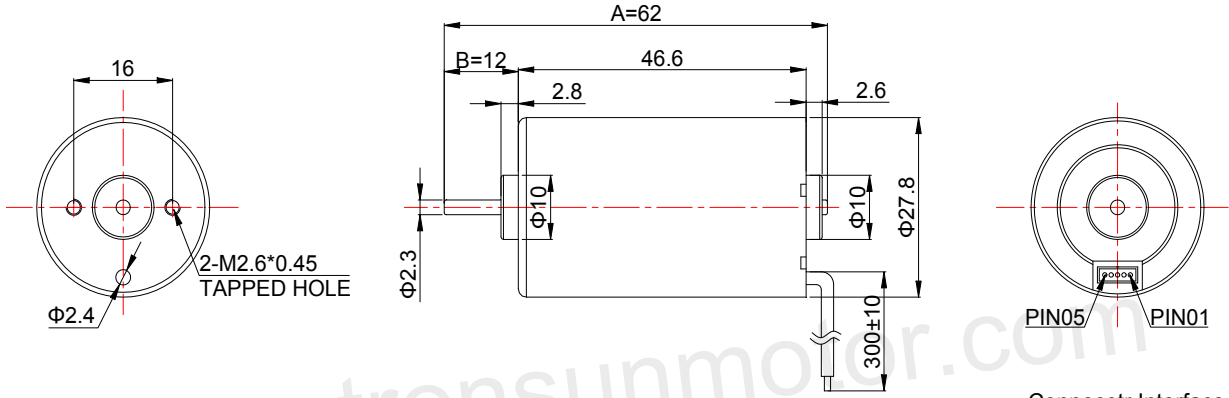

Customizable Parameters:

1. Length A and B
2. Electric Performance

WEIGHT: 92g(Approx)

View:



Connecetr Interface

NO.	PIN ARRANGEMENT
1	VCC (Red Wire)
2	FG(Green Wire)
3	CW/CCW(Yellow Wire)
4	GND(Black Wire)
5	PWM(Blue Wire)

2. MOTOR PERFORMANCE :

MODEL	VOLTAGE		NO LOAD		AT MAXIMUM EFFICIENCY				STALL			
	OPERATING RANGE	NOMINAL	SPEED	CURRENT	SPEED	CURRENT	TORQUE	OUTPUT	TORQUE		CURRENT	
		V	rpm	A	rpm	A	g.cm	mN.m	W	g.cm	mN.m	A
BL2847I-126000	8.0~15.0	12.0	6000	0.14	5000	0.68	110	10.79	5.64	662	64.97	3.34
BL2847I-128500	8.0~15.0	12.0	8500	0.25	7100	1.26	150	14.72	10.92	920	90.28	6.42
BL2847I-249200	8.0~26.0	24.0	9200	0.21	7650	1.03	210	20.61	16.48	1260	123.65	5.12

